



Centrifugal pumps

**Advanced Pumping Solutions for the Food, Beverage,
Pharmaceutical, and Chemical Industries**

Centrifugal pumps

Pumps manufactured in AISI 316L stainless steel.

Their modular design enables easy maintenance, while ensuring reliable operation.

They provide a robust and durable solution, suitable for both demanding industrial processes and sanitary applications.

Centrifugal pumps for flooded suction

CTF Serie



Centrifugal pump suitable for food and industrial applications

STF Serie



Centrifugal pump designed for pharmaceutical use (WFI, purified water, etc.)

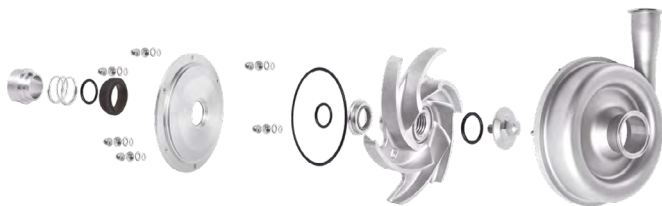

- **Max. flow rate:**
160 m³/h - 2900 rpm
- **Max. differential pressure:** 80 m
- **Temperature:** From -10°C to 140°C
- **Max. power:** 30 KW

- **Max. flow rate:**
220 m³/h - 2900 rpm
- **Max. differential pressure:** 95 m
- **Temperature:** From -20°C to 180°C
- **Max. power:** 90 KW

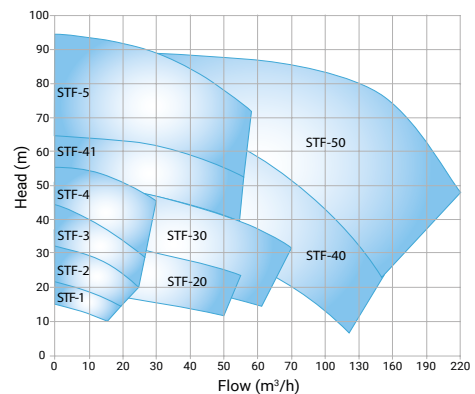
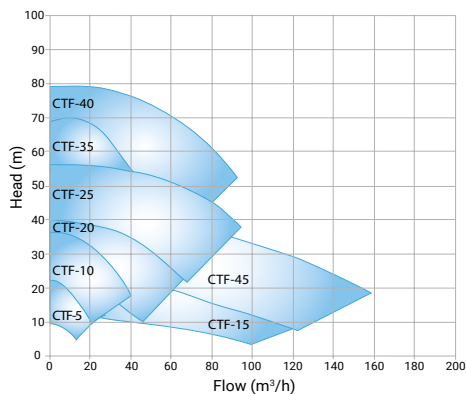

Test conditions:

Water in standard conditions, 20°C,
impeller speed 2900 RPM

Centrifugal pumps

Self-priming centrifugal pumps

Handles fluids with air or gas bubbles. Ideal for CIP return systems and for draining tanks and pipelines.

LPTF Serie

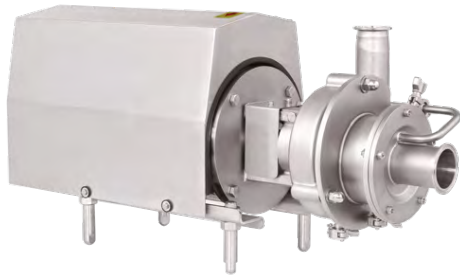

Self-priming centrifugal pump with inducer



- **Max. flow rate:**
50 m³/h - 2900 rpm
- **Max. differential pressure:** 42 m
- **Succión máxima:** 8 m
- **Temperature:** -20°C to 140°C
- **Max. power:** 22 KW

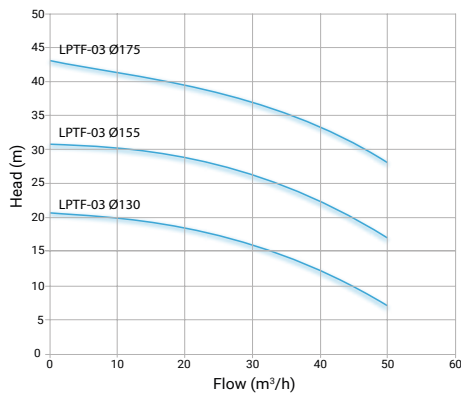

LTF Serie



Self-priming liquid ring centrifugal pump

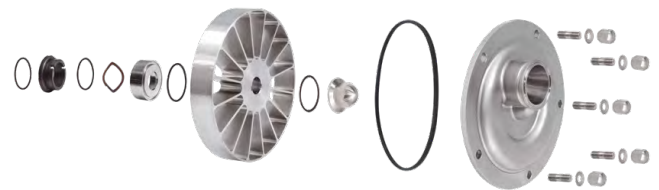

- **Max. flow rate:**
84 m³/h - 1450 rpm
- **Max. differential pressure:** 50 m
- **Succión máxima:** 8 m
- **Temperature:** -20°C to 140°C
- **Max. power:** 15 KW

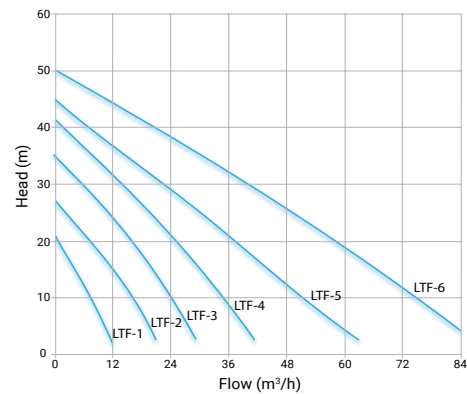

Test conditions:

Water in standard conditions, 20°C,
impeller speed 2900 RPM

Materials

- **Wetted parts:** Machined 316L stainless steel.
- **Impeller:** AISI-316L stainless steel. Open impellers of various diameters in the CTF and STF series.
- **Mechanical seal:** SiC/SiC or TC/TC single or double with flush.
- **FDA O-rings:** EPDM, FKM, NBR, FFKM and FPMX.

Surface finished

- Hygienic quality, hand-polished welds.
- Parts in contact with the fluid with options Ra <0.8, Ra<0.5, mechanical finishing, and electropolishing.

Connections

- **Industrial:** BSP thread, NPT thread, EN1092-2 flange
- **Sanitary:** DIN11851 thread, SMS thread, DIN11864-2 flange, ASME BPE clamp

Certificates and Compliance



CTF-STF



ATEX – certified product range:

The CTF and STF models are ATEX marked for use in:

- Areas with flammable gases/vapors:
ZONE 1 y ZONE 2 (**II 2G Ex h IIB/IIC T4 Gb**)
- Areas with combustible dust:
ZONE 21 y ZONE 22 (**II 2GD Ex h IIIC T135°C Db Gb**)

Common mechanical seal size

CTF	CTF-05	CTF-10	CTF-15	CTF-20	CTF-25	CTF-30	CTF-35	CTF-40	CTF-45	
STF	STF-01	STF-02	STF-2D	STF-03	STF-3D	STF-04	STF-41	STF-4D	STF-05	STF-5D
LTF	LTF-1	LTF-2	LTF-3	LTF-4	LTF-5	LTF-6				
LPTF	LPTF-03									

Applications



• **Pharmaceuticals:** Water for injection (WFI) and purified water (PW).



• **Food and beverage:** Juices, tea-based drinks, wine, beer, milk, dairy products.

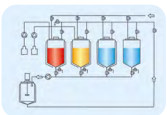

• **CIP cleaning systems.**



• **Process:** Heat exchangers, filtration units, brine injectors.



• **Chemical industry application:** Pesticides, insecticides, herbicides, fertilisers.

Application Data Sheet: Centrifugal pumps

Pump Type: Centrifugal

Process Requirements

Positive installation head

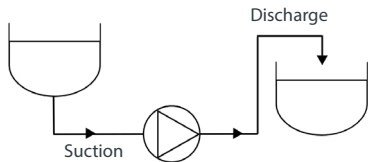

Negative installation head

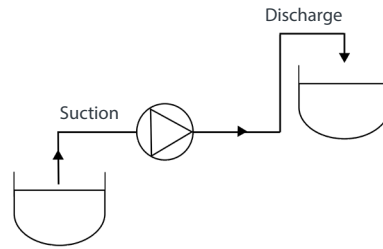

Suction Line

High (m) Length (m) Ø pipe (mm)

Adicional accesories

Discharge Line

High (m) Length (m) Ø pipe (mm)

Adicional accesories

Duty

Continuous Intermintent Hours per day

Assembly location Outside Inside

Corrosive environment Yes No Temperature environment and humidity

Process Parameters

Flow Rate l/min Max Pressure Bar

Fluid description

Name

Concentration

Max Viscosity (cP @ °C)

Does the end product tend to foam?

Density (Kg/m3)

No A Little A Lot

ProcessTemp (°C)

Is the fluid abrasive?

Max Temp (°C)

No Slightly Very

Solids Yes No Quantity (%) Size (mm)

Flow Properties similar to:

Requirements

Connections Polish Gasket material

Electrical Requirements

Voltage Phase Hz IP Inverter Yes No



 info@stursan.com

 www.stursan.com